

TO THE HAUNTS OF THE BORN

TO THE HAUNTS OF THE BORN

Sunday, July 13, 1965

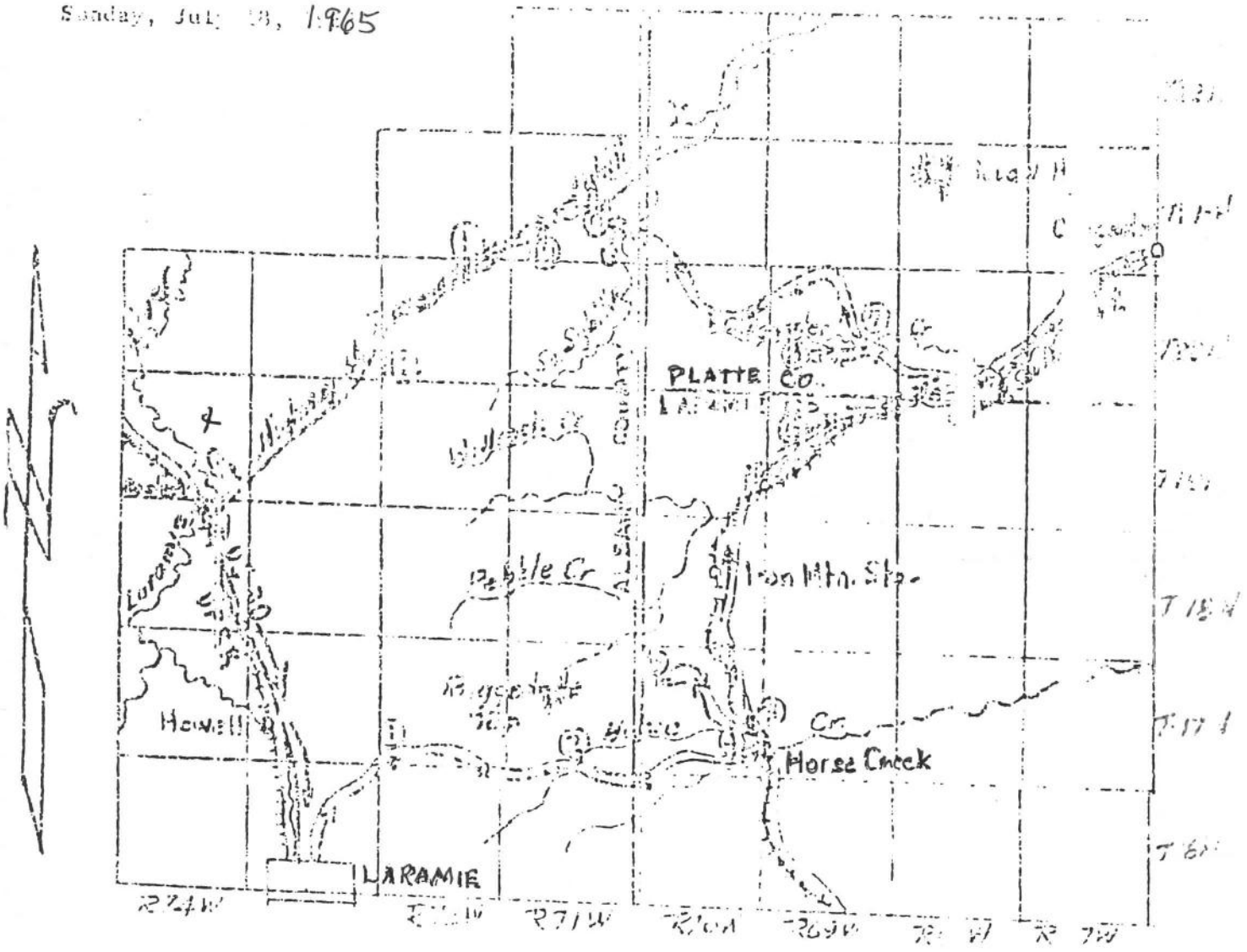

Scale 1:100,000

1. Rock Quarry - University building store.
2. McKechnie Ranch
3. Tugman Ranch
4. Reginold O. Whitaker Ranch
5. Where Lewis was killed
6. C. S. Jordan Ranch.
7. Gus Miller's Ranch
8. Where Mickell boy was killed
9. Med DeVore's Ranch
10. Game Department
11. Fitzorris R.
12. Archal

Fifteenth Annual Old Time Ranch Tour
Sunday, July 13, 1965

To the Honors of Tom Horn

This Tour is sponsored by The Albany County Historical Society, The University Summer School, and the Kiwanis Club.

These Old Time Ranch Tours strive to create interest in the heritage which is ours in this high plains country. The ranches operating today go back to the beginning of the range livestock industry in the West, which occurred right here on the Laramie Plains and adjoining mountains.

This tour has been arranged by Dr. Robert H. "Bob" Burns, A. S. "Bud" Gillespie, Bill Riedl, John Paulson, George Burgess, Colonel Arthur Hodge, Mr. and Mrs. Forrest S. Blunk, Oliver Knight and Art McKechnie, Sr.

The roads will be partially oil, graded gravel and country. The general route will be to the east of Laramie as well as north-east and the final lap will be from the north where we will come onto Highway 30 at Bosler.

We will be in close sight of where each - Fred W. Powell, Bill Lewis and Willie Nickell was killed, where the Linghoff's were caught killing beef, and we will wind up at the Old Coble Ranch where Horn made his headquarters for two years prior to his arrest for the killing of Willie Nickell. The total mileage of the trip will be about 245 miles.

The tour will depart from the Court House Square at 7:00 a.m. Come a little early to receive instructions and arrangements for rides for those who have lunch but no transportation. All of those having transportation are asked to report to A.S. Gillespie, Phone 745-3030, prior to Sunday morning if possible.

The rate of speed suggested is around 50-60 miles on the oil highway and 30 to 45 miles per hour on graded country roads, depending on curves, surface condition of road, etc.

Each driver is urged to allow a "between-car" distance of several hundred yards between cars, to keep out of the dust on gravel roads and allow faster "non-tour" cars to pass the caravan on the paved highway.

The ranch folks on the route extend rest room facilities which places a responsibility on tour members to respect the property of their ranch hosts. These ranch owners welcome our tour and give what anecdotes they have of their ranches past and present. They are quite naturally fearful of grass and general fires during the dry weather, so tour members must take every precaution in smoking.

If you must smoke, use the ash tray in your car, and do not flip cigarette or matches from your car. Make sure they are out.

Be careful about picking up souvenirs and ask any of us, or particularly the ranch owner, before taking away any souvenir. It may seem worthless to you, but it may be used during a portion of the year, as were some branding irons hanging on a fence at a seemingly abandoned ranch corral, which we were forced to ask the tour member to return to their place.

Make use of the following schedule or "Log" of the Tour and map on the cover. These schedules will be distributed at the Court House Square, one to each car, and extras will be available at the noon-day stop. At noon please register your name and home town on the booklets provided by the Tour Directors, as we wish a roster of those attending our Tour. Our Tour Directors, are experienced at the parking of the cars and if you will follow their instructions the tour will move with clock-like precision.

The State Highway Patrol will escort the Tour while we are on Public Highways.

Today we are visiting the Haunts of Tom Horn, Cattle Detective and representative of an era which passed with him. Before taking the tour you will be interested in reading the following publications dealing with Tom Horn. He was at once a commanding, efficient, and tragic figure in the cattle history of the west. His actions have aroused controversy, and have become almost legendary. Read the following publications and come and join us for a day when you will see many kinds of country, and some interesting landmarks connected with a vibrant period in our range history.

Life of Tom Horn. An autobiography and vindication.

Published for John C. Coble by Lothian Book Company, Denver

U.W. Library Book No. B/ H784

Thompson, John Charles 1946

The Hanging of Tom Horn

The Westerners Brandbook 1945 pp. 111-129 (Denver Posse)

U.W. Library Book No. Hebard Room 978 W255b

Monagan, Jay 1946

Last of the Badmen. The legend of Tom Horn.

Indianapolis and New York: Bobbs Merrill & Co.

U.W. Library Book No. B/ H78m

Book Review in: The Westerners Brand Book (Chicago). III:6: 40. Aug. 1946

U.W. Library 973 W5251 v3 1946/47

Denver Times, August 5, 1901. Wyoming Feuds Latest. Iels Nickell, father of assassinated boy shot three times.

Denver Times. May 22, 1902. Your Life is in Danger. A Wyoming rancher receives a dread warning, similar to those that preceded the murders of Lewis and Powell.

Denver Republican. Nov. 19, 1903. Horn's funeral this afternoon.

Krakel, Dean F. 1954

The saga of Tom Horn. The story of a cattlemen's war

Laramie, Wyo., Powder River Press. U.W. Library 1/ H784k

Paine, Lauran 1963

Tom Horn: Men of the West.

Barre, Mass. Barre Publ. Co. U.W. Library Hebard Room B/ H78 4p

Stops will be made at the Powell, Lewis, Miller and Nickell, Langhoff and Coble ranches, all intimately connected with the legendary haunts of Tom Horn in his war on rustlers. People who are intimately acquainted with these incidents will speak at these stops.

This schedule gives all of the landmarks and ranches which will be passed en-route to the scope and by carefully using the schedule you can become well acquainted with these landmarks. Have someone in each car handle the schedule, which you will receive at the Court House Square, Sunday morning, July 18, 1955, 6:45 a.m.

The Tour leaves the Courthouse Square sharp at 7:00 a.m. If you miss the take-off, go east any street to NINTH STREET and turn north and overtake the caravan.

PLACE	TIME	ELEVATION	M I L E A G E	
			Local	Trip
LARAMIE				
Malody Homestead on Right	7:00	7105	0.0	0.0
Rifle Range	7:07		3.8	3.8
Kingman Corrals	7:07	7200	2.4	6.2
Spur Range. To Right	7:12	7300	1.2	7.4
Cyrus Mann. To Left two miles. He used to raise cream colored horses with white tails and manes.				
Sheep corral	7:15		0.2	7.6
Sheep corral	7:17		1.4	9.0
Frank King homestead which was the beginning of the King Bros. Company.				
Rock Quarry where University gets its building stone	7:18		0.3	9.3
Cattle guard	7:19		0.1	9.4
Rogers Canyon	7:19		0.4	9.8
Divide	7:23	8000	2.1	11.9
The old Rogers Ranch to the south on Sec. 29-17-71. Roger owned a shed where he could house 15,000 head of sheep in a blizzard. In one blizzard he lost 7,500. To the left is the ANORTHROSITE dpositite used in the production of aluminium. Many tons of this ore has been trucked to the Momolith plant south of Laramie to be used in the proposed aluminium plant.				
Intersection To Left	7:25	7800	0.4	12.3
Cattle gard	7:27	7600	0.4	12.7
McKechnie Ranch guard	7:32		3.5	16.2
Ragged Top	7:33		0.2	16.4
Road Junction	7:34		0.3	16.7
Cattle guard	7:35		0.5	17.2
McKechnie Ranch (Formerly Powell's)	7:36		1.5	18.7
Cattle guard	7:43		0.5	19.2
Green Top	7:46		0.2	19.4
Intersection.	7:46		0.0	19.4
Cattle guard	7:47		0.2	19.6
Road to where Powell was shot.	7:58	7800	3.6	23.2
Hill where Powell was shot. STOP	8:05-8:25		0.0	23.2
Gate	8:30		0.8	24.0
Intersection	8:34		0.4	24.4
Cattle guard	8:36		1.0	25.4
Cattle guard	8:36		0.5	25.9
Cattle guard	8:39		0.9	26.8
Cattle guard	8:45		3.4	30.2
South Fork of Horse Creek	8:49		1.0	31.2
Cattle Guard	8:50		0.4	31.6
Cortney Davis Ranch STOP	8:51-9:10		0.7	31.8
Cattle guard	9:11		0.3	32.1
Cattle guard	9:12		1.2	33.3

PLACE	TIME	ELEVATION	M I L E A G E	
			Local	Trip
Railroad	9:12	7800	0.0	31.3
Intersection to Hi:	9:14		0.2	33.5
Tugman Lanch	9:23		0.5	34.1
Reginoid O. Whitaker STOP	9:25-9:45		1.4	35.5
Wire Gate	9:59		1.0	36.5
Wire Gate	10:01		0.2	36.7
Railroad	10:01		0.0	36.7
Wire Gate	10:01		0.0	36.7
Wire Gate	10:06		0.0	36.7
Railroad Grade. Where limestone was hauled.	10:09		2.3	39.0
Quarry Draw	10:13		1.0	40.0
Cattle guard	10:14		0.0	40.0
Intersection	10:15		0.7	40.7
Wire Gate	10:15		0.0	40.7
Where Lewis was killed. STOP	10:19-10:40	6800	0.8	41.5
Wire Gate	10:42		0.8	42.3
Cattle guard	10:44		0.4	42.7
Railroad	10:49		1.4	44.1
Wire Gate	10:50		0.5	44.6
Wire Gate	10:55		1.7	46.3
Railroad	10:55		0.0	46.3
Wire Gate	10:55		0.0	46.3
Wire Gate	10:58		0.2	46.5
Leava Whitakers	11:02		0.0	46.5
Highway (Yellowstone)	11:05		1.0	47.5
Cattle guard	11:10		4.5	52.0
Cattle guard	11:11		0.8	52.8
Intersection. Left to Farthing Ranch	11:14		1.2	54.0
Intersection	11:14		1.5	55.5
Cattle guard	11:15		0.1	55.6
Cattle guard	11:19		2.5	58.1
Railroad	11:19		0.0	58.1
Opposite of Iron Mountain and Station				
Cattle guard	11:19		0.0	58.1
Cattle guard	11:26		1.4	59.5
Underwood Place. To Right.	11:27		0.1	59.6
Cattle guard	11:30		1.0	60.6
J. L. Jordan STOP Now Frank & Son	11:34-12:35		1.6	62.2
Cattle guard	12:39		1.4	63.6
Leaving Jordan's	12:46		2.8	66.4
Crossing Railroad (Colorado Southern R.R.)	12:54		3.6	70.0
Old AL Ranch. To Left	1:00	p.m.	5.1	75.1
High McDonald. Ranch to Right.	1:06		6.1	81.2
Crossing Colorado Southern R.R.	1:15		9.0	90.2
Red Foss Ranch on Chugwater Creek	1:26		12.0	102.2
Junction North Chugwater Creek	1:37		11.0	113.2
Road to Jess Miller's	1:37		0.0	113.2
Cattle guard	1:37		0.0	113.2
Cattle guard	1:47		11.1	124.3
Morrison Ranch. D. Piper present owner.	2:02		14.0	138.3
Old 40 Ranch buildings	2:20		18.0	156.3
Gus Miller's	2:32		6.3	162.6
Gate	2:34		0.4	163.0
Intersection	2:37		0.5	163.5

PLACE	TIME	ELEVATION	M I L E A G E	
			Local	Trip
Where Nickoli boy was killed	STOP			
Corrales	2:57-3:20		10.2	173.7
Wire Gate	3:33		3.6	177.3
Returned to Miller's	3:39		1.8	179.1
Billy Clay Ranch	3:40		0.3	179.4
	3:46		2.3	181.7
<p>He was a Virginian and was a descendant of the great state man Henry Clay who imported the first registered Short-horn cattle to Virginia. He was one of the first pioneer cowboys who worked for The SWAN LAND & CATTLE COMPANY. He had 'color' enough for another (Wen Wister, Billy Clay lived on Mile Creek. Several ranches are below him and are good ones too.</p>				
<p>NOTE: Laramie Peak to the North. Highest peak in the range. Altitude about 10,000 feet above sea level.</p>				
<p>Observe Hog-Backs on West Rim of Dead Head Basin.</p>				
<p>Bray Ranch, owned by the late George Martin.</p>				
Cattle guard	3:51		0.5	182.2
Cattle guard	3:52		0.2	182.4
Cattle guard	3:54		0.8	183.2
Cattle guard	3:56		1.0	184.2
Lawrence Rosentrator (New buildings)	3:57		0.5	184.7
Cattle guard	4:00		1.1	185.8
Cattle guard (See Squaw on Squaw Mountain	4:03		1.4	187.2
Cattle guard to north and ahead)	4:08		2.8	190.0
Cattle guard	4:23		1.9	191.9
Ned Dover's (Ned passed away recently)	4:24		0.8	192.7
Cattle guard	4:25		0.1	192.8
Cattle guard	4:26		0.5	193.3
Highway 14. Go to left,	4:26		0.0	193.3
Earl Flaherty. To right.	4:26		2.0	195.3
Vern Martens STOP (To right where Horn did his				
first detective work.)	4:27-4:47		3.4	198.7
School House	4:48		0.0	198.7
Magnitite Mines to right.	4:48		0.0	198.7
Main Sybille	4:49		0.3	199.0
Pasture on left for wild game.	4:49		1.3	200.3
Game Department to left.	4:49		1.3	201.3
School Creek. To right.	4:52		2.3	203.9
Fitzmorris Ranch. Past year present owner	4:54		2.0	205.9
Sheep Rock. High Mountain to right.	4:55		0.5	206.4
Bear Creek. Hiding place for bears.	4:56		1.2	207.6
Long Canyon. To left.	4:58		1.4	209.0
<p>Gets its name by being so straight for so great a distance. The canyon appears as a great 'gouge' out of the earth. It is inhabited by thousands of rattlersnakes. It is notorious for them.</p>				
Long Canyon Peak to the left.	4:59		1.3	210.3
<p>It is the highest peak and the sharpest pinnacle in this vicinity. It's crest has never been scaled.</p>				
Sybille Canyon. To right. Very scenic.	5:00		0.8	211.1
Morton Pass. Highest point on the road.	5:01		1.4	212.5
Sybille Springs. To right where creeks are.	5:02		0.0	212.5
Sybille Creek. Main Sybille we cross.	5:04		1.4	213.9

Dead Man's Cave

Received it's name from a man that was found dead in June 1900. To the left you will see two groups of caves in the limestone formation. The man's body was found to the left of the two farthest south. He started on foot to Laramie in March 1900 from the Iconoclas Mine on the Blue Grass. A blizzard came up and he became exhausted and went into the cave for shelter and sat down in the back end of the cave, which was quite comfortable and resembled an arm chair. To get out he would have to fall forward. He had his overcoat spread over his knees. It is presumed that he fell asleep and never aroused. Mike Fitzmorris, a boy about fourteen years old found the body while looking for swallow nests. He was frightened and started home on a high lope. He met a prospector by the name of Gavett who went back with Mike to investigate. He thought the man asleep but he was buried a few yards from where he was found. He was buried by the coroner. The man's name was Palmerson.

Plumbago Canyon To Left.

5:05

0.9 214.8

Plumbago Canyon has a small stream flowing out onto the plains north into the Sybille Creek. William Radichal and wife settled there in that canyon in 1886. One daughter still lives there. Could Mrs. Radichal have lived from February until the next September she would have lived centruy. In front and west of Plumbago Canyon the late S. W. Gillespie killed the last buffalo in south-eastern Wyoming in July 1881. The Laramie Plains is in front of you -- a vast tract of land between the Laramie Mountains on the east and the Medicine Bow Mountains on the west, and Boulder Ridge to the south and almost to Bates Hole on the north. The plains average 700 feet in elevation.

Elk Mountain

3:19

1.2 216.0

A pleasing sight to the west is about fifty miles away. It's elevation is slightly over 11,000 feet. The Medicine Bow range or so called Snowy Range (Named for the center section) is to your right. The blue color indicates evergreen timber. Medicine Bow Peak is the highest point and has banks of perpetual snow. The Snowy Range has many cold, clear water lakes which are stocked with trout. This area furnishes relaxation, scenery and fishing to thousands of visitors each year. The elevation of the peak is around 12 thousand feet.

Farley's Ranch

A family located a stock grazing homestead here. He raised sheep, potatoes and milked cows. Gate Creek on the east flows into Low Lake.

Blue Grass Knoll. Off to right about six miles.

Miss Mable Hayford, school teacher and daughter of the late Judge J. H. Hayford of Laramie who published the Laramie Sentinel, taught school at the Gillespie ranch. She took her oldest pupil, the late J. W. Gillespie, and they took a flag and pole, climbed the knoll and raised the flag and built a pile of rocks around the knoll which held it in position for many years. The monument still stands.

Blue Grass Ridge. Look back to the right.

It extends about four miles west, then turns north for a distance of 14 miles. It acquired it's name from the rich blue grass which grows on it and the Blue Grass Flats. Nature provided an everlasting water hole not far from the center of these Flats which is known as the Blue Grass Well. It's water

level remains the same regardless of weather or large numbers of livestock watering there. As many as 3000 head of cattle and several hundred horses have watered there in one day in the open range days.

Long Lake. About three miles to the west.
It is about three miles long and three quarters of a mile wide in the widest place. It is strong in alkali, and receives the waste water from the Boughton ranch.

Ben Smith Ranch (Gillespie Ranch 8 miles northwest)	5:07	1.5	217.5
Son of Ben Smith To Right	5:07	0.0	217.5
Wall Rock Creek	5:09	2.5	220.0
Road to Coble Ranch	5:10	0.5	220.5
Wire Gate			
Cattle guard	5:14	0.7	221.2
Boughton Ditch. Water for Coble Ranch	5:15	0.7	221.9
Cattle guard	5:19	1.8	223.7
	5:20	0.1	223.8

Ben Smith's ranch is a Sheep Ranch, They raised the usual sized family of twelve who have worked on the ranches of this region and Medicine Bow. The Gillespie Ranch can be seen some nine miles north-west and is distinguished by metal roofs on the buildings. It was settled by the late S. W. Gillespie in 1883. On this ranch was the well-known Lake Ione which the old timers claimed was bottomless, and some of them ventured to say they has seen sea serpents in it. The ranch expanded from a 160 acres holdings to around 21,000 acres of deeded land. Schmale Brothers are the present owners.

Observe the livestock reservoirs to the west which were built under the program set up under the late President Franklin D. Roosevelt.

Coble Ranch	STOP	5:21-5:41	0.6	224.4
-------------	------	-----------	-----	-------

The Coble Ranch was settled by an Englishman named E. S. Boughton in 1883. Mr. John Whitaker bought this ranch from Mr. Boughton in about 1892 and sold it to the Iron Mountain Ranch Company, owned by the late John C. Coble and Frank C. Bosler in the spring of 1900. The beneficiary, Mrs. Frank C. Bosler, Wallis Brothers. They in turn sold a large portion of it to John Bell of Iron Mountain. This is the ranch where Tom Horn made his headquarters from 1900 until his arrest for the killing of Willie Nickell.

Cattle Guard				
Schmidl Ranch	To Left	6:00	1.1	225.5
Laramie River		6:03	0.5	226.0
McFarlane Ranch to Right		6:06	0.8	226.8
Harlow To Left		6:06	0.0	226.8
Highway 30		6:07	0.8	227.6
Bosler		6:08	0.3	227.9
		6:09	1.0	228.9

Ghost Ranch	To Left by River	6:10	0.0	228.9
-------------	------------------	------	-----	-------

This ranch acquired its name by the casualties which occurred here. In March of the early days, five men went out to do some duck hunting along the Laramie River. They used a team and wagon to get to their hunting grounds. A three-day blizzard came up. They had a tent but it didn't have flaps to come down to the ground to keep the snow and wind out. They could

not find wood to use to keep a fire burning. They were compelled to turn their horses loose to keep them from freezing to death. The five men perished in that storm.

A few years after that a 19 year-old boy drowned when he attempted to swim a horse across the river there to go to Hutton Station for the mail.

Laramie River		6:11	1.2	230.1
Boughton Ditch. To irrigate Coble Ranch		6:11	0.4	230.5
Oasis Ditch		6:13	2.1	232.6
This ditch was built by Ora Haley in 1890 to irrigate the Oasis, Wyoming and Ghost Ranches. Wyoming Station on the U.P.R.R. was Ora Haley's shipping point after 1901 when the cut-off was made to Rawlins which left Old Wyoming Station some five miles to the west where the bend of the Laramie River is located. Ora Haley was the richest man ever in the cattle business in Albany County and built the home now occupied by the American Legion Home. There are three ranches visible a short distance right and west of Wyoming Station. In the center of the bottom is the Oasis Ranch formerly owned by Ora Haley now owned by Lloyd Brothers.				
Howell Station		6:16	3.3	235.9
McMechanic Ranch	To right where trees are.	6:17	0.8	236.7
Roy Lumburg Ranch	Two miles to left.	6:19	0.8	237.5
Ranch to east with large windbreak. Formerly owned by William Krueger, who has built up a nicer ranch starting with a veterans homestead in 1919.				
King Brothers Ranch		6:19	1.8	239.3
To the south and east the King Brothers red roofed buildings show in the distance. Notice number of sheep sheds and camps each with a windmill for watering the sheep. This ranch was visited by the 1951 OLD TIME RANCH TOUR. It is now owned by Frank C. Bosler who grows Black Angus cattle where fine-wooled Rambouillet sheep once grazed.				
Aunt Mary Erhardt	Old stone house to right.	6:25	5.3	244.6
Laramie		6:29	0.9	245.5

There are several other ranches along the Laramie River from Howell Station on to Laramie; all these ranches were described in the 1951 OLD TIME RANCH TOUR.

So long, and we hope you have enjoyed the Fifteenth Old Time Ranch Tour!