

RANCH STOPS ON OLD TIME RANCH TOURS July 18, 1970
Map No. 1

Big Laramie River Ranches

1. Oxford Horse Ranch - now Lembcke's
2. Flag Ranch - now Pitchfork Ranch
3. Heart or Hutton Ranch
4. Riverside Ranch - now Ray Lewis
5. Olson Ranch - now Wm. Windsor
6. Sodergreen Ranch. Luncheon Stop
7. Johnson, Everett & Wes
8. Mountain Meadow Ranch - now Wm. Windsor
9. Boswell Ranch - now Wm. Hunt Estate
10. Hutton-Tatham Ranch - now U-T of Richard Leake
11. Diamond Tail Ranch - now Morton White



SCALE
1" = 4 MILES

End of Tour

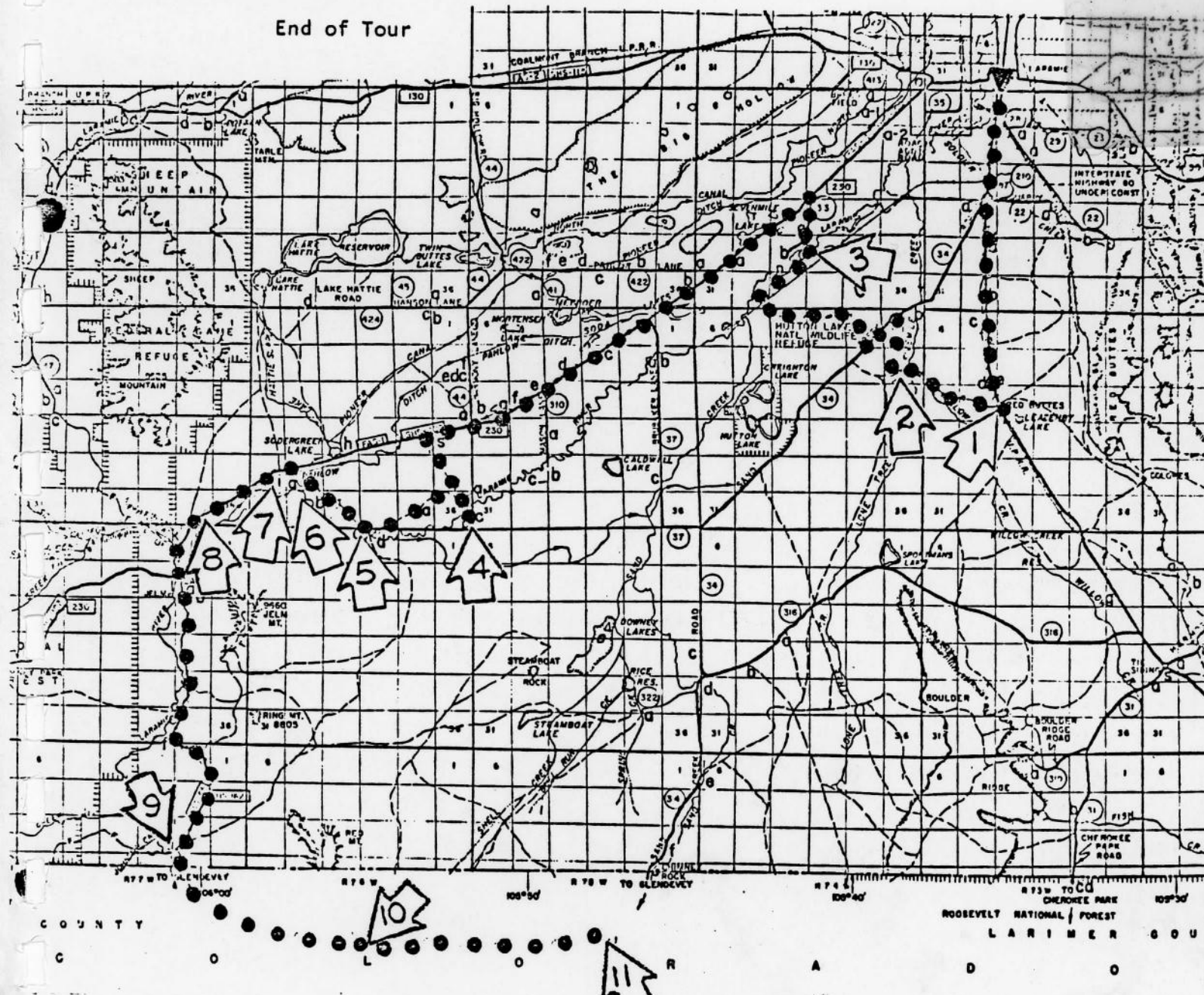

BSG LARAMIE RIVER OLD TIME RANCH TOUR

Centenary Anniversary: "100 years of Beef from Laramie
Plains Grass"

The Laramie Plains can well be called the cradle of the western livestock industry for it was on these plains that the Pioneers noted the fat wild life including deer, elk, antelope, and buffalo. The Indians came every summer for the fine hunting afforded here and there was much warfare among the tribes for the privilege of using these plains for a summer hunting ground.

The first written reference to the discovery that abandoned work oxen, thin from a long summer of work on the trail, would turn up fat in the spring was also recorded on these Laramie Plains. (Wyoming's Pioneer Ranches, pp. 3-14) A confirmation of the incident is related by John Alsop about his father, Tom Alsop, finding abandoned oxen of Ed Creighton, fat and healthy after a winter spent in the area southwest of Laramie has been found by the writer in December 1969. (Leonard, L. U. Building First Pacific Telegraph Line. Boise Newspaper, Creighton University Library). This item states that Ed Creighton sent out as far as Fort Sanders, something like 150 head of oxen in the late fall of 1860. The oxen reached Fort Sanders in November. The Fort was short of fodder and it was decided to turn the oxen loose in a protected valley about 16 miles southwest of that place, where there was fine feed, and let the oxen hustle for themselves during the winter. In the spring when Creighton was ready to start work on the telegraph line he sent one of his men (probably Tom Alsop RHB) out from Fort Sanders to learn how many of the oxen had survived and how many more he would have to bring out from Omaha, to make up the losses. The animals were found, to everyone's great surprise, in fine shape and health. Mr. Creighton remarked that he now knew that these western valleys were good for and this was the real beginning of large investments in cattle in later years.

Mr. Creighton formed the firm of Creighton, Hutton and Alsop and in late 1869 established one of the first livestock ranches in the West at the site of the Big Laramie Stage Crossing and that is the Heart Ranch which has come down to this time and will be the third stop on our tour today.

This tour is sponsored by the Wyoming University Summer School, the Albany County Historical Society and the Laramie Kiwanis Club.

Bring your car, lunch, drinking water, mosquito dope and a grand sense of adventure and join this tour which leaves the ALBANY COUNTY COURTHOUSE SQUARE promptly at 8:00 a.m. The caravan must keep together. We set our speed on the preliminary tour at 60 mph on oiled main highways, and 30 mph and less on country gravel roads.

The Wyoming State Patrol will guide us on the oiled roads. Please be prompt in taking off after each stop and let the lead cars go out ahead. We will cross the railroad in some places so be very CAREFUL.

The locations of the ranches to be visited are shown on the accompanying map in chronological order as follows:

1. Oxford Horse Ranch. Whitehouse & Stokes, Whitehouse and Palmer, etc. and presently owned by Otto Lembcke.
2. Flag or Homer Ranch. Robert de H. Homer, Sargent and Homer, Sargent, Homer and Evans. Fred Klink, and present owners Pitchford Ranch, of Guthrie County, Texas.
3. Heart or Hutton Ranch. Creighton, Hutton & Alsop. Charles Hutton, etc. Present Operator, Cole Abbott.
4. Riverside Ranch. Ealch and Bacon, Schmidt, etc. (Tarkio Farms), present owner Ray Lewis.
5. Olson Ranch. Hans Olson, Ralph Holland and present owner Wm. Windsor.
6. Sodergreen Ranch. Oscar Sodergreen, Schmidt, etc. (Tarkio Farms). Present owner Ray Lewis.
7. Mountain Meadow Ranch. Jake Lund, Baby Peggy Montgomery, Embree. Present owner Wm. Windsor.
8. Coswell Ranch. N. K. Coswell, C. J. Oviatt, Etc. Present owner, Wm. Hunt Estate.
9. Hutton Horse Ranch. Tatham Bros. U-T Ranch, etc. Present owner Richard Leake.
10. Diamond Tail Ranch. Martin Bros., A. D. V. Baldwin, Charley Owen, Jim Vanderwork, A. Benzinger and present owner, Morton White.

ACKNOWLEDGMENT is made to the sponsors of both tours, the Summer School of the University of Wyoming, the Kiwanis Club, and the Albany County Historical Society. The following Kiwanians have had active parts in carrying out these tours: Jim Nelson, Col. Hodges, John Paulsen, George Benges, Bill Riedl, Phil Tideman and Bob Burns.

BIG LARAMIE RIVER OLD TIME RANCH TOUR.
 Centenary Celebration, ~~Summer of 1970~~
 100 Years of Beef from Grass on Laramie Plains---

JUL 18 1970	Time	Mileages		References to pages in Wyoming's Pioneer Ranches
		Local	Trip	
Albany County Courthouse Square	8:00	0.0	0.0	
Jct. turn left on So. 3rd and on out Highway #287.				
Jct. Turn left near Red Buttes	8:10	9.2	9.2	
Oxford-Horse Ranch: Whitehouse- Palmer: Lembcke STOP	8:12-8:35	0.2	9.4	204, 203-206, 199
Return to Highway "287 and turn rt	0.2	9.6		
Jct. Flag Ranch Sign: Turn left	8:37	0.2	9.8	
Cross railroad	8:37	0.1	9.9	
Cattle guard	8:40	1.7	11.6	
" "	8:42	0.7	12.3	
" "	8:43	0.4	12.7	
Flag RANCH (Homer-Klink-Pitchfork STOP)	8:44-9:15	0.1	12.8	148, 152, 151- 158, 161-187
Cattle Guard & Jct. Turn left on County Road	9:18	1.8	14.6	
Cattle Guard	9:23	2.4	17.0	
Jct. Turn right on graded road	9:24	0.4	17.4	
On left is sign Hutton Lake Wildlife Refuge.				
Jct. Turn left off of graded road	9:26	1.5	18.9	
Jct. Turn right and follow along wire fence & along foot of hill to left.	9:27	0.4	19.3	
Wire gate and railroad crossing: then turn to right thru ditch and over meadow.	9:30	1.5	20.8	
Gate and fence	9:34	0.8	21.6	
Cross rough ditch CAREFUL	9:35	0.4	22.0	
HEART-HUTTON Ranch STOP	9:39-10:15	0.7	22.7	146-151
Bridge over Big Laramie River	10:17	0.7	23.4	
Jct. Turn left on Highway #230	10:19	1.2	24.6	
Bill Robison Ranch on right	10:22	2.7	27.3	
Pahlow Lane on right	10:23	0.6	27.9	146, 188
Monolith Quarry Sign on right	10:24	0.7	28.6	
12 Mile hill	10:25	1.4	30.0	
Nelson Road Ranch:	10:28	2.2	32.2	
LeRoy Lane on left	10:29	1.3	33.5	51, 144, 146, 391
Hatch Ranch on right	10:30	0.2	33.7	
Lippold Ranch on right	10:31	0.7	34.4	
Mazel Ranch on right	10:32	0.3	34.7	
Conoco Station on right	10:33	1.0	35.7	
Harmony Lane on right	10:33	0.1	35.8	
Jct. Turn left: Harmony School on left	10:35	0.3	36.1	
Cattle Guard	10:39	2.1	38.2	
Bridge over Big Laramie River	10:40	0.3	38.5	
Riverside Ranch Balch & Bacon, Schmidt, Lewis STOP	10:42-11:12	.2	38.7	139, 141-144

	Time	Mileages	References to pages in Wyoming Pioneer Ranches
Jct. Turn left over graded road	11:15	0.7	39.4
Cattle guard	11:16	0.3	39.7
Bridge over ditch	11:17	0.3	40.0
Eike Ranch on right	11:19	0.9	40.9
Cattle Guard	11:21	0.3	41.2
" "	11:25	1.1	42.3
Jct. Turn right	11:27	0.4	42.7
Cattle Guard	11:29	0.3	43.0
Olson-Holland-Winson Ranch	11:30-12:00	0.3	43.3 L44
Cattle Guard & Pole Gate	12:04	0.9	44.2
" "	12:05	0.4	44.6
" "	12:06	0.1	44.7
" "	12:07	0.4	45.1
Sodergreen Ranch STOP LUNCH	12:09-13:15	0.3	45.4 138-140
Jct. turn left	13:16	0.4	45.8
Cattle guard with green wheels	13:18	0.5	46.3
Wes Johnson Ranch STOP	13:20-13:50	0.3	46.6 L39
Jct. Turn left	13:53	0.9	47.5
Cross Pioneer Canal	13:53	0.0	47.5
Jct. Highway #230 Turn left	13:54	0.1	47.6
Jct. Turn left. Sign Mt. Meadows Ranch	13:58	3.1	50.7
Mountain Meadow Ranch: Jake Lund	13:59-14:20	0.2	50.9 L37, L38
Jct. Highway #230 Turn left	14:31	0.2	51.1
Former Jelm P.O. & School House on right. Site of movie "Man from Painted Post with Douglas Fairbanks	14:33	1.0	52.1
Woods Landing on right. Cross Bridge over Big Laramie River	14:35	0.9	53.0 L36, L35
Laramie River Fishing area right	14:38	2.3	55.3
Cummins City: Old Jelm: Frank Smith at right across River	14:40	1.8	57.1
Cattle guard	14:43	2.5	59.6
Boswell Ranch: Hunt STOP	14:46-15:15	2.3	61.9 L29-132
Jct. Turn right	15:16	0.2	62.1
Colorado State Line	15:17	0.4	62.5
Cattle guard	15:22	2.8	66.3
" "	15:26	2.1	68.4
Jct. Turn right	15:27	0.5	68.9
U-T ranch. Hutton-Tatham-Leake STOP	15:28-15:58	0.2	69.1 L35, L49, 191, 310
Jct. Turn right	15:59	0.1	69.2
Cattle Guard	16:00	1.3	70.5
Wagnild Ranch on right	16:01	0.6	71.1
Cattle Guard	16:02	0.9	72.0
" "	16:03	0.5	72.5
" "	16:04	1.2	73.7
Jct. 4-way: Straight ahead	16:05	0.2	73.9
Jct. Turn right downhill	16:06	0.8	74.7
Diamond Bar Tail Ranch: White	16:07	0.3	75.0 L32, L35

END OF TOUR.

RANCH STOPS ON OLD TIME RANCH TOURS July 19, 1970

Map No. 2

Little Laramie River Ranches

1. King Bros. Ranch - now Frank Bosler
2. Biddick Ranch
3. Pascoe-Coen-Burns Ranch - now Page Three Bar
4. Carroll Ranch
5. Alsop Ranch - now Ralph May
6. Bath Ranch. Stone House now Al Sherwood
7. Fleming Ranch - now Al Wessels
8. Judson-Black-Sutphin - now Whitney (Luncheon Stop)
9. Mandel Main Ranch - now Miller Bros. Home Ranch
10. Mandel Section 10 Ranch - now part of Lobhan Place
11. Motley-Sanderson Ranch
12. Farrell-Wallis-Forbes Ranch
13. Wright-Fillmore-now George Crouse Vee Bar (Buffalo Herd)
14. Sanders 91 - now Marvin Howard
15. Buckeye Ranch - now Glenn Ranch
16. Pratt-McNealey Ranch - now Ed Anderson
17. Wolbol-Rhinesmith-Dinwiddie & Mason - now owned by Smith and Sons



SCALE
1" = 4 MILES

End of Tour

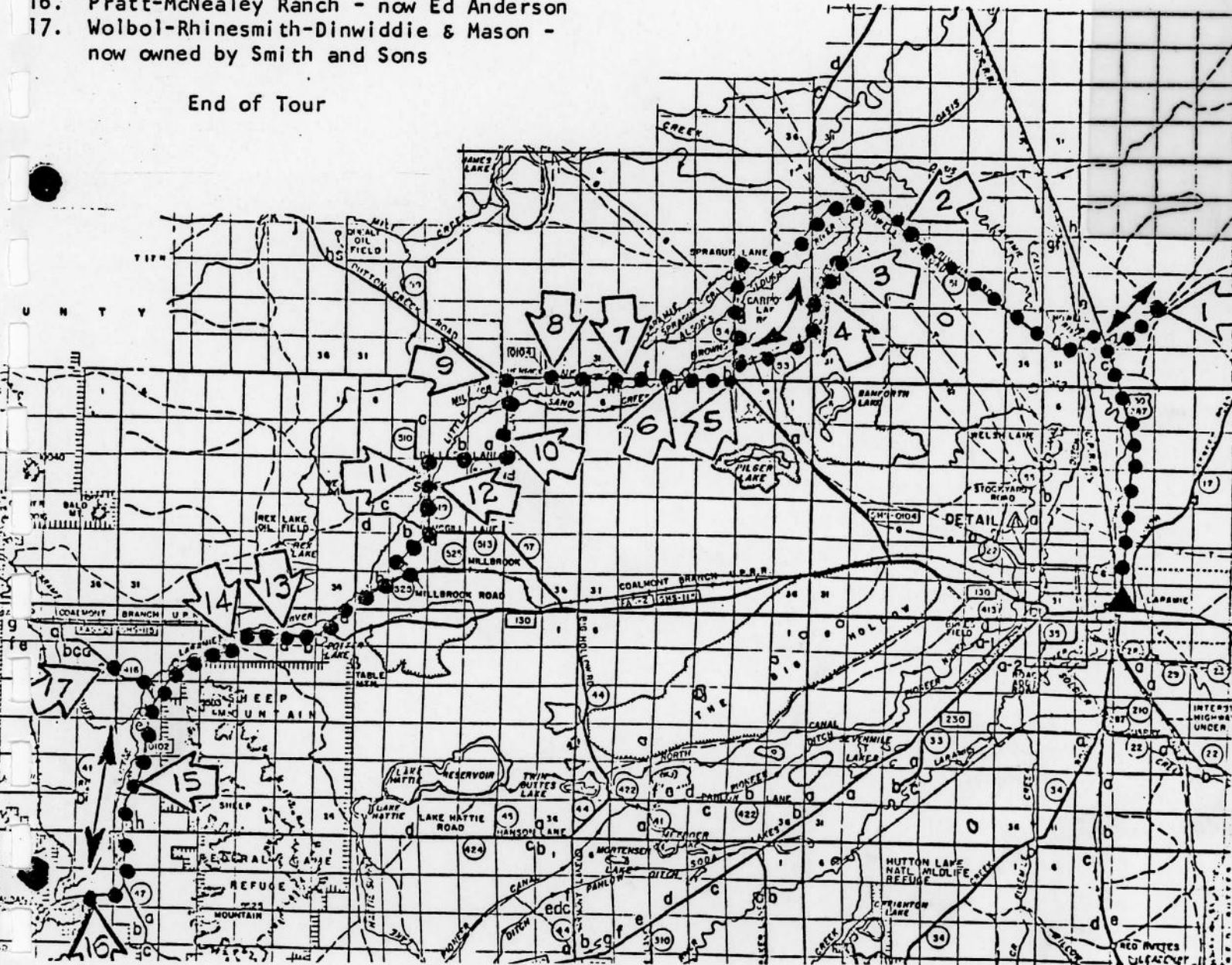

LITTLE LARAMIE RIVER OLD TIME RANCH TOUR
Centenary Anniversary: "100 years of Beef from
Laramie Plains Grass"

~~July 19, 1970~~

JUL 19 1970

The Little Laramie Valley has always been known for its fine hay crops and accordingly was the site of the first haying operations on the Laramie Plains. When the army at Fort Sanders needed hay for its horses it contracted with early day ranchers to furnish hay. In fact some of the hostlers etc. at the Fort, including Mike Carroll, took some of these contracts to cut and deliver native hay to the Fort. Ed Farrell was another hay contractor as was Bob Homer and Charley Hutton.

When English investors were attracted to the Valley, while on hunting and exploration trips, some of them stayed and developed large ranches and raised some of the finest livestock, particularly horses. The Douglas-Willan, Sartoris Company at its Millbrook Ranch, spent large sums of money not only in the Little Laramie Valley, but also in the mines at Keystone and at other ranches near Douglas.

There are so many early day ranches in the Little Laramie Valley that it is not possible to visit all of them. The first ranches were on the Big Laramie River, but shortly afterwards the ranches on the Little Laramie were settled and developed. The following stops will give the tour members some idea of the great variety of people who followed ranching in the Little Laramie Valley since the 1870's.

(Bring your car, lunch, drinking water, mosquito dope, and a top sense of adventure and join the tour which leaves the ALLANY COUNTY COURTHOUSE SQUARE promptly at 7:00 A.M. The caravan speeds have been set on the preliminary tour schedule. On oiled highways it is 60 mph., while on country gravel roads it is 30 mph or less, according to road conditions. The Wyoming Highway Patrol will guide us on the oiled highways. We cross the railroad in some places so be very CAREFUL.)

1. King Brothers, Frank, Bert and Joe King. Frank Bosler and Howard Carroll. World Famous Sheep breeding establishment of King Brothers who developed Rambouillet and Corriedale Sheep in this area.
2. Biddick Ranch. One of the first Shorthorn ranches in the State and still raising fine Shorthorns. Started by Jack Biddick and now operated by his daughter Ethel Biddick.
3. Pascoe Ranch. Three Bar Ranch. Paul Pascoe, Jim Coen, Otto Lurns, and present owner, Thos. H. Page.
4. Carroll Ranch. Started by Mike Carroll and carried on through three generations by Tom Carroll, and now Mrs. Tom Carroll and Howard Carroll.
5. Alsop Ranch. Ellsworth Chase, Tom Alsop, etc. Present owner Ralph May.

6. Bath Ranch (Stone House) Henry Bath, Fred Bath, Al Bath, Phil Bath, etc.
Present owner of Stone House, Al Sherwood. Bath Brothers, Earl, Alwyn and Harry Bath.
7. Fleming Ranch. Douglas-Willan Sartoris & Co. E. J. Bell
Present owner A. Wessels.
8. Judson-Black-Sutphin-Fisher-Herrick-Palmer Ranch. Whitney-Carroll
9. Mandel Ranch Wm. Lawrence John Ernest, Swift. Present owner
Miller Bros. Home Ranch.
10. Mandel Ranch (Section 10) Phil Mandel in 1880. Hopkins Gurley
Present owner is Ed Loban.
11. Motley-Sanderson Ranch.
12. Farrell-Wallis-Forbes Ranch.
13. Wright-Fillmore Ranch. Now called Vee Bar Ranch. Later owners
Leonard Hein, Geo. Crouse.
14. Brown, Gresley-Robbins-Logan, 91 Ranch. Wm. Irvine, Sanders
Schakel and present owners.
15. Buckeye Ranch. Dole Bros. Connor, etc. Present owner Glenn.
16. Pratt, McNealey Ranch. Present operator E. Anderson.
17. Walbol, Rhinesmith, Mason and Dinwiddie Ranch. Present owner
Smith & Son.

ACKNOWLEDGMENT is made to the sponsors of both tours, the Summer School of the University of Wyoming, the Kiwanis Club, and the Albany County Historical Society. The following Kiwanians have had active parts in carrying out these tours: Jim Nelson, Col. Hodges, John Paulsen, George Berzes, Bill Riedl, Phil Tideman and Bob Burns.

Little Laramie River Old Time Ranch Tour.

Centenary Celebration. ~~July 7, 1970~~
 100 Years of Beef from Grass on Laramie Plains.

Place	JUL 13 1970	Time Mileages		Ref. to pages in Wyoming's Pioneer Ranches.	
		Local	Trip		
Albany County Courthouse Square		7:00	0.0	0.0	---
Diamond Horseshoe on left		7:06	2.8	2.8	---
Earhart Stone House on left		7:07	0.5	3.3	45, 50, 209
O.K. Corral on right		7:10	3.5	6.8	---
Jct. turn right over cattle guard		7:11!	0.3	7.1	---
Cattle guard		7:12	0.3	7.4	---
" "		7:13	0.6	8.0	
King Bros. Ranch (Bosler) STOP	7:15 - 7:	34	.7	8.7	521-557
Jct. with Highway 30: turn right		7:40	1.9	10.6	
Howell Jct. Turn left onto #51		7:41	0.6	11.2	
Cross U.P.R.R. tracks		7:43	0.7	11.9	
Cross Bridge over Big Laramie River		7:43	0.1	12.0	
Jct. Turn right on old R.R. grade		7:46	0.8	12.8	
Cattle guard		7:47	0.5	13.3	
Red Ranch (Lloyds) on right		7:47	0.5	13.8	212, 216, 217
Von Powell deserted barn on left		7:48	0.4	14.2	212
Cattle guard		7:49	0.4	14.6	
" "		7:50	0.6	15.2	
" "		7:51	0.9	16.1	
" "		7:52	0.8	16.9	
Jct. turn right		7:54	0.6	17.5	
Biddick Ranch STOP	7:57 - 8:	10	1.3	18.8	213-214
Jct. turn right		8:15	1.3	20.1	
Cattle Guard		8:15	0.9	21.0	
Two Rivers: Old Wyoming Station to left		8:17	0.9	21.9	214, 216
Cattle guard & bridge over Little Laramie River		8:18	0.3	22.2	
Jct. Turn left along fence		8:19	0.5	22.7	
Jct. through wire gate & turn left		8:29	3.3	26.0	
Cattle guard & into Sprague Lane		8:32	1.0	27.0	
Sprague Ranch (Miller Bros.) on rt.		8:33	0.2	27.2	308, 310
Puls Ranch (Scott) on left		8:34	0.4	27.6	308
Rogers Ranch (Johnson) on left		8:35	0.3	27.9	299, 306
Johnson Ranch on left		8:36	0.5	28.4	
Bridge over Brown Creek		8:39	1.3	29.7	
Jct. Turn left over cattle guard		8:40	0.3	30.0	
Gallagher-Beaumier Ranch on left (Darcy, Carroll & Gaddis)		8:41	0.4	30.4	306
Cattle Guard		8:41	0.1	30.5	
" "		8:43	0.6	31.1	
" "		8:44	0.8	31.9	
" "		8:46	0.9	32.8	
Stickney Ranch (Yarborough-Johnson) on left		8:47	0.1	32.9	310
Cattle Guard: Carroll Ranch left		8:49	0.6	33.5	
Pascoe on Three Bar Ranch (Page) STOP		8:53-			
		9:15	1.2	34.7	307, 309, 311-314

Place	Time	Mileages	Reference to pages in Wyoming Pioneer Ranches
Carroll Ranch STOP	9:21-10:00	1.2 35.9	303, 305, 310-312
Cattle Guard: Stickney Ranch rt.	10:01	0.6 36.5	310
West Carroll Lake on left	10:02	0.6 37.1	
Cattle Guard	10:03	0.4 37.5	
" "	10:05	0.8 38.3	
" "	10:07	0.6 38.9	
Gallagher & Beaumier Ranch rt. (Darcy-Carroll-Gaddis)	10:08	0.2 39.1	306
Cattle Guard & Jct. turn left into Sprague Lane	10:08	0.3 39.4	
Jct. with oil road. Turn right into Herrick Lane #57	10:09	0.3 39.7	
Alsop Ranch (R. May) STOP	10:-10:30	0.7 40.4	297, 300-306
Caillie-Kaisler Ranch on right	10:31	0.9 41.3	
Bridge and underpass	10:31	0.2 41.5	
Henry Bath Ranch (Stone House) (Sherwood) STOP	10:32-11:00	0.2 41.7	287-300
Jct. Wessell Mailbox. Turn right thru wire gate	11:01	0.6 42.3	
Wire Gate	11:02	0.4 42.7	
Fleming Ranch (Wessell)	11:06-11:30	0.6 43.3	268, 270, 272
Jct. Mail box & Herrick Lane Turn right	11:35	1.0 44.3	
Little Laramie Community Hall left	11:35	0.2 44.5	
Bath Bros. Ranch on left	11:36	0.3 44.8	288-300
Judson-Sutphin-Fisher Ranch LUNCH		1.8	
Herrick, Palmer, Whitney STOP	11:40-13:00	46.6	284-287
Turn left from oil road	13:00	0.2 46.8	
Cattle guard	13:01	0.1 46.9	
Flag markers on left for Little Laramie Stage crossing	13:05	0.8 47.7	
Abrams-Lawrence Ranch on left	13:06	0.1 47.8	288, 299
Cross Mandel Lane #57	13:06	0.1 47.9	
Mandel Ranch (Ernest, Swift and Miller Bros. Home Ranch) STOP	13:07-13:35	0.5 48.4	276, 278, 279, 283
Return to Mandel Lane and turn rt.	13:36	- --	
Bridge over Little Laramie River	13:37	0.7 49.1	
Mandel Ranch on Section 10 STOP	13:38-14:00	50.1	279, 278
Old Stage Station Blacksmith Shop			
Jct. Turn right on Dallas Lane #51	14:03	0.8 50.9	
Dallas Ranch on right	14:09	1.9 52.8	284
Jct. Turn left into Wallis-Forbes Lane	14:09	0.2 53.0	
Jct. Turn right thru gate!	14:11	0.4 53.4	
Motley-Sanderson Ranch STOP	14:12-14:30	0.3 53.7	280, 282, 283, 285
Return to Wallis-Forbes Lane and turn right	14:31	0.3 54.0	
Jct. Turn left over cattle guard	14:32	0.1 54.1	
FARRELL-WALLIS-FORBES Ranch STOP	14:33-15:00	54.4	177, 260-266
Return to Wallis-Forbes Lane and turn left	15:00	0.1 54.5	

Place	Time	Mileages		Ref. to Pages in Wyoming's Pioneer Ranches
		Local	Trip	
3-way corner, deviate to right & across cattle guard	15:03	1.3	58.8	
At mailbox (Croonberg) bear left	15:06	1.1	56.9	
Towle-Croonberg Ranch on right				253, 258
Cattle guard and railroad crossing				
Turn right along railroad	15:09	0.4	57.3	
Hatton Station & Oil Racks on rt.	15:12	1.8	59.1	
Gilbert Cabin on right	15:13	0.5	59.6	
Cross Cattle guard and turn right onto Highway 130	15:14	0.6	60.2	
Jack's Place on left	15:15	0.2	60.4	
Jct. & mailbox: Turn rt. over guard	15:17	0.8	61.2	
Cross bridge over Little Laramie Riv.				
WRKJIT: Fillmore: Vee Bar Ranch				
Buffalo Ranch STOP	15:18-15:30	0.4	61.6	249-252
Return to Highway 130 and turn rt.	15:33	0.4	62.0	
Jct. turn left on Albany Road #0102	15:36	0.8	62.8	
May-Twist-Bow & Fiddle Ranch on rt.	15:37	1.0	63.8	249, 251, 252
Jct. Turn right at sign 91 Ranch	15:38	0.3	64.1	
Bridge over Little Laramie River	15:39	0.2	64.3	
Brown-Gresley-Robbins-Logan-Irvine and 91 Ranch STOP	15:42-16:15	0.3	64.6	235, 238-244, 246 -248.
Return to Albany road #0102 Turn rt.	16:17	0.5	65.1	
Power Sub-Station on right	16:18	0.9	66.0	
Olson Ranch on right	16:20	1.3	67.3	256
Jct. Turn right at Buckeye sign	16:22	1.3	68.6	
Buckeye Ranch: Dole, Connors, Glenn STOP	16:23-16:50	0.3	68.9	
Return to Albany Road & turn right	16:51	0.3	69.2	
Jct. Mailbox: Bird-Geddes Ranch rt.	16:52	0.3	69.5	236, 237
Hecht & Sundby Ranches to left	16:53	0.6	70.1	234
Buckeye School on right	16:54	0.3	70.4	
Jct. Fox Creek road: turn right	16:56	1.7	72.1	
Albany	17:00	2.5	74.6	
Pratt-McNealy Ranch STOP	17:02-17:25	0.8	75.4	237
Jct. Highway #0102 Turn right	17:29	0.5	75.9	
Jct. Fox Creek Road: turn left staying on oil	17:30	1.4	77.3	
Buckeye School	17:32	1.9	79.2	
Hecht & Sundby Ranches to right	17:32	0.2	79.4	234
Jct. turn left over cattle guard	17:37	3.1	82.5	
Bridge over Middle Fork	17:37	0.1	82.6	
Cattle Guard	17:41	0.9	83.5	
" "	17:41+	0.1	83.6	
Jct. "Rock Pillars" Turn left	17:43	0.4	84.0	
Wolbol-Rhinesmith-Dinwiddie & Mason Smith Ranch STOP	17:49-18:05	1.4	85.4	236
Return to "Rock Pillars" turn left	18:11	1.4	86.8	
Jct. Highway #130 turn left	18:16	1.7	88.5	
Centennial	18:19	0.9	89.4	

END OF TOUR